

2 1 900

\$400,000

1816 Primavera Ct, Santa Rosa, California

RINCONADA PARK RETREAT: MODERN COMFORT
MEETS NATURE'S DOORSTEP



DESCRIPTION

Experience park-side living in this bright, one-level end unit in the heart of Rincon Valley. Located in the Mission Creek PUD, this charming home directly faces beautiful Rinconada Park, offering serene views and light-filled rooms. The interior is move-in ready with contemporary flooring, updated appliances, and modern windows. Comfort is guaranteed with central AC and heat, while the convenience of in-unit laundry and two parking spaces (one covered, one uncovered) makes daily life a breeze.

Step outside to explore over two acres of lush green parkland, two community pools, and a walkable, pet-friendly atmosphere. You are perfectly placed near local favorites like Oliver's Market at Montecito Center and Sarmentine Organic French Bakery in Mission Plaza. Proximity to the Rincon Valley Library, Madrone Elementary, and public transit adds to the effortless lifestyle. The comprehensive HOA covers water, landscaping, and exterior maintenance of the roof, paint, and fencing. Dues also include a robust Master Insurance Policy (walls-in/replacement cost) and separate earthquake insurance.

*See original image at bit.ly/3MzWNSf

SONOMACOASTLIVING.COM

Sonoma Coast
Living
REAL ESTATE SERVICES

DEREK STEFAN

REALTOR® / DRE#02250511

415.336.8651

derek@sonomacoastliving.com



All data, including all measurements and calculations of area, is obtained from various sources and has not been, and will not be verified, is not guaranteed by broker and is subject to change. All information should be independently reviewed and verified for accuracy.

1816 Primavera Court, Santa Rosa, CA

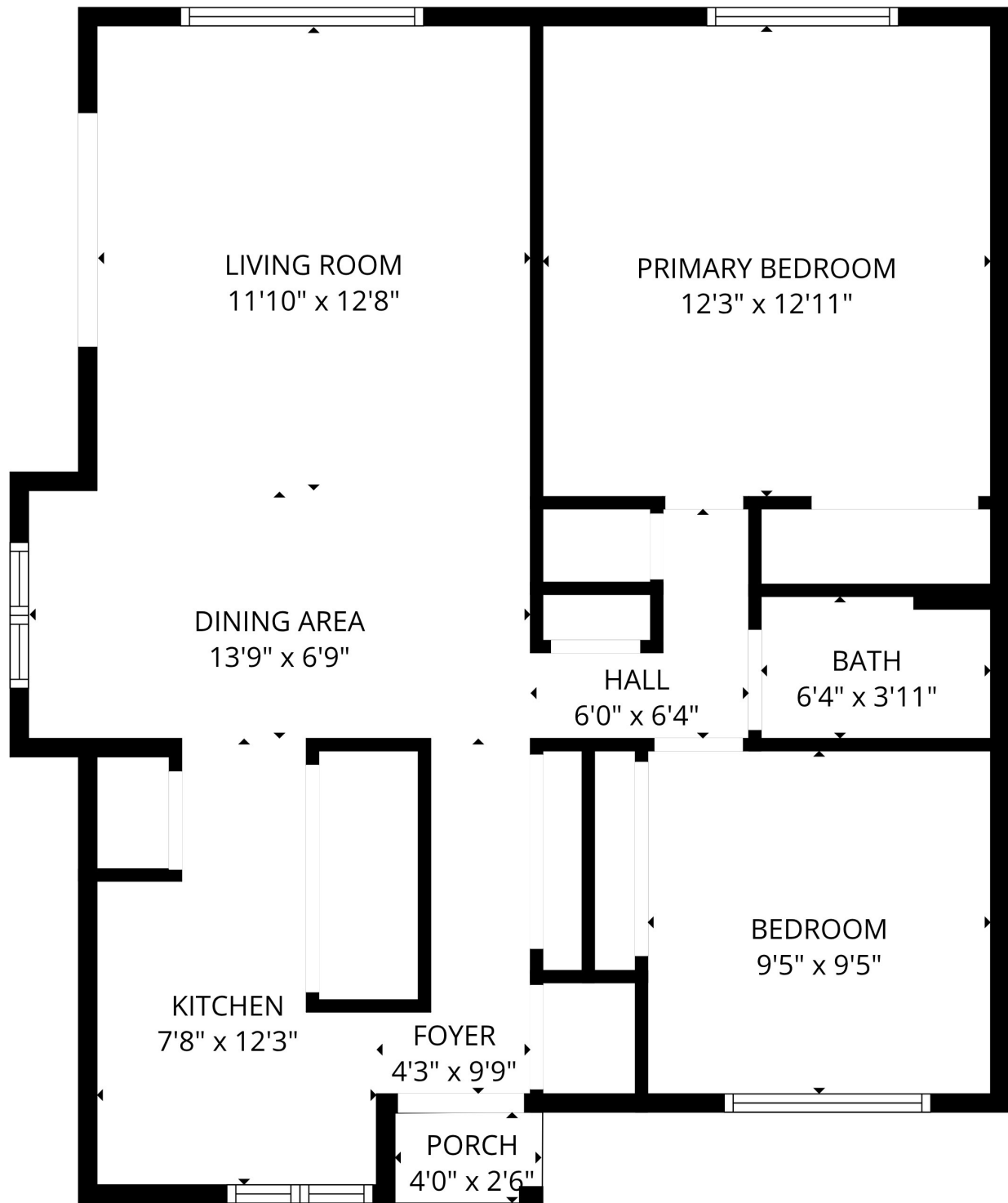

FLOOR PLAN CREATED BY CUBICASA APP. MEASUREMENTS DEEMED HIGHLY RELIABLE BUT NOT GUARANTEED.

SONOMACOASTLIVING.COM

Sonoma Coast
Living
REAL ESTATE SERVICES

DEREK STEFAN
REALTOR® / DRE#02250511
415.336.8651
derek@sonomacoastliving.com

